



27 Bond Road

Ashford, TN23 7UG

Offers In Excess Of £270,000

A pleasantly appointed semi - detached home close to Ashford town centre and International station. Under the same ownership for the last 50 years, this delightful home enjoys a southerly facing rear garden which backs on to allotments and comprises an entrance hall, sitting room, dining room, kitchen, bathroom and three bedrooms. The property benefits from gas fired central heating and double glazing and is available to view by appointment only.

Viewing

Please contact our Ashford Office on 01233 646411 if you wish to arrange a viewing appointment for this property or require further information.

- SEMI DETACHED HOUSE
- THREE BEDROOMS
- TWO RECEPTION ROOMS
- GENEROUS REAR GARDEN
- BACKING ON TO ALLOTMENTS
- SHORT WALK TO TOWN & STATION
- GAS CENTRAL HEATING
- DOUBLE GLAZING

Floor Plan

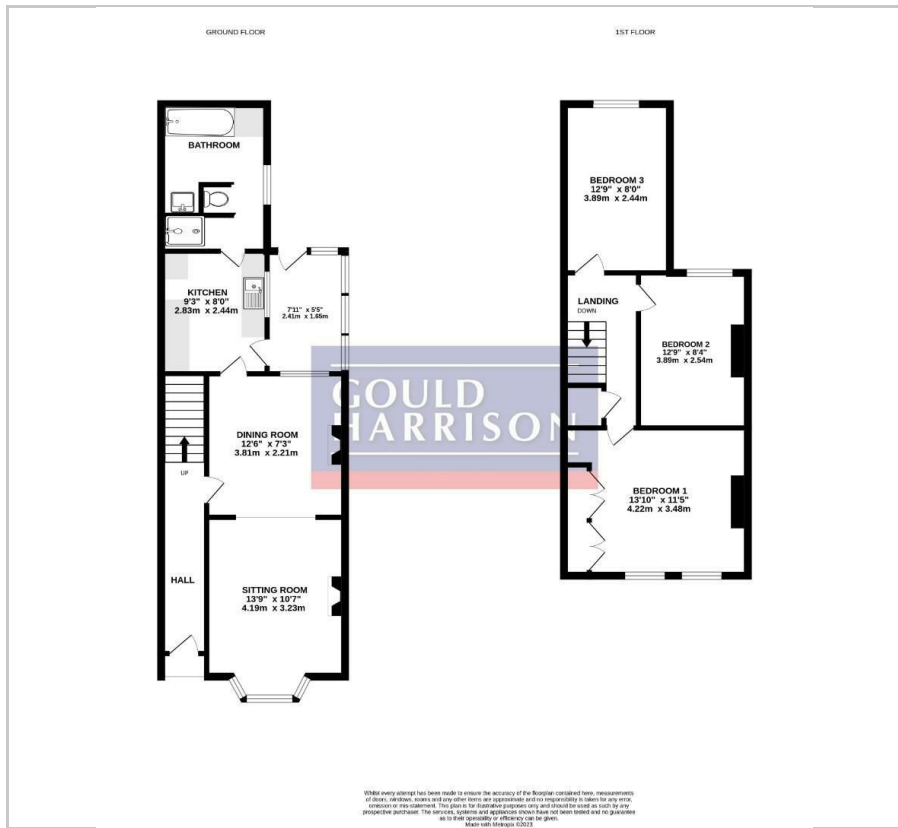

Area Map



Energy Efficiency Graph

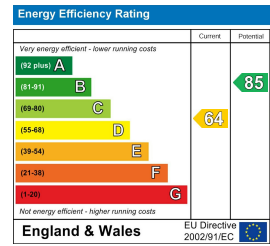

These particulars, whilst believed to be accurate are set out as a general outline only for guidance and do not constitute any part of an offer or contract. Intending purchasers should not rely on them as statements of representation of fact, but must satisfy themselves by inspection or otherwise as to their accuracy. No person in this firm's employment has the authority to make or give any representation or warranty in respect of the property.